

FOOTHILL BUSINESS PARK

A Multi-Tenant Business Park

960 - 3,903 Sq. Ft. Office And Industrial Space For Lease

6 months
of half
rent!*

*Restrictions Apply



20321, 20331, 20371, 20381 Lake Forest Drive • Lake Forest, California



ALLEN BASSO
Senior Vice President
License ID # 01298152
949.790.3130
abasso@lee-associates.com

RYAN HARMAN
Vice President
License ID # 01399616
949.790.3136
rharman@lee-associates.com

Lee & Associates - Irvine, Inc.
111 Pacifica, Suite 310
Irvine, California 92618
www.lee-associates.com



No warranty or representation is made to the accuracy of the foregoing information. Terms of sale or lease and availability are subject to change or withdrawal without notice.



FOOTHILL BUSINESS PARK

A Multi-Tenant Business Park

20321, 20331, 20371, 20381 Lake Forest Drive • Lake Forest, California

Property Features:

- Leasing incentives possible
- Retail amenities nearby
- Excellent 241 Toll Road access
- Individual tenant signage
- Cox Cable/internet available
- 12'x12' ground level doors
- Separately metered utilities
- Fire sprinklered
- 2.8:1,000 parking ratio
- 100 amps, 3 phase power
- 16' to 20' warehouse clearance

Site Map:

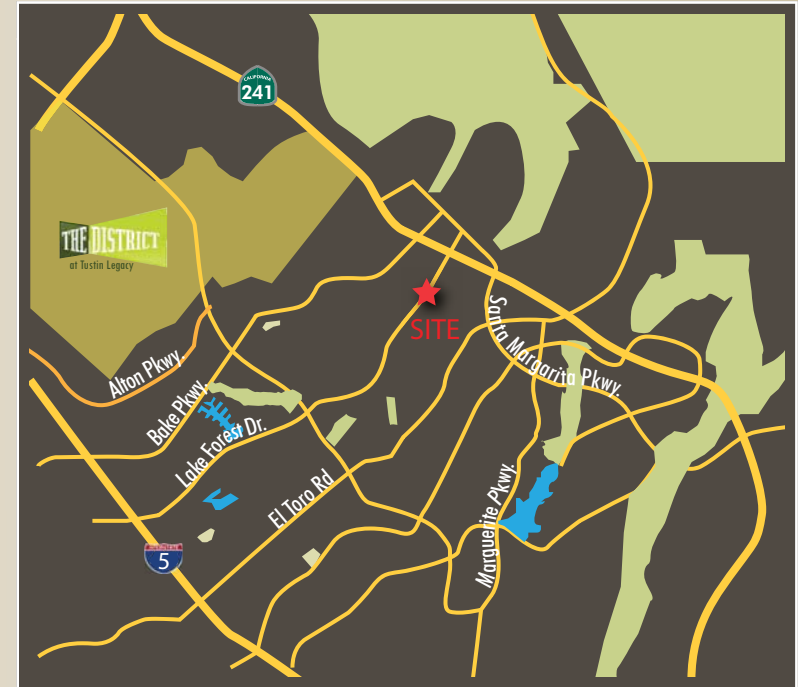
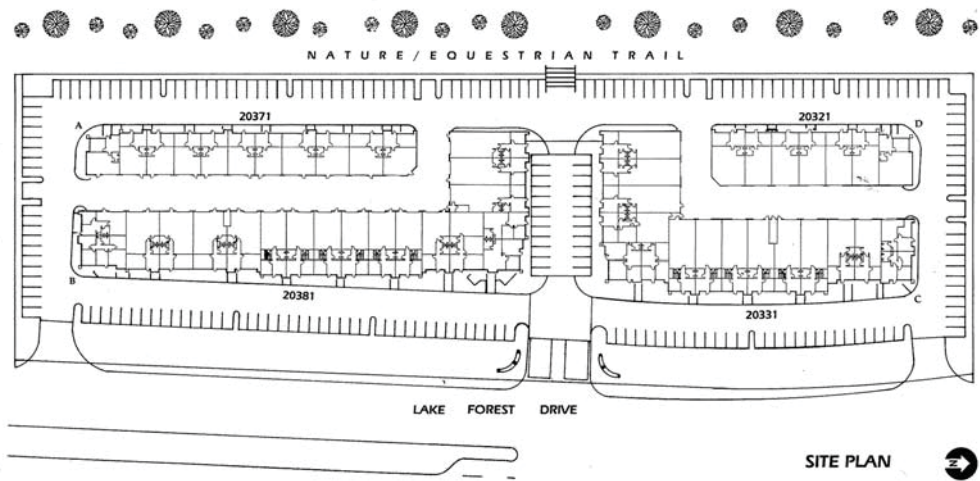

ALLEN BASSO
Senior Vice President
License ID # 01298152
949.790.3130
abasso@lee-associates.com

RYAN HARMAN
Vice President
License ID # 01399616
949.790.3136
rharman@lee-associates.com

Lee & Associates - Irvine, Inc.
111 Pacifica, Suite 310
Irvine, California 92618
www.lee-associates.com



No warranty or representation is made to the accuracy of the foregoing information. Terms of sale or lease and availability are subject to change or withdrawal without notice.



FOOTHILL BUSINESS PARK

A Multi-Tenant Business Park

20321, 20331, 20371, 20381 Lake Forest Drive • Lake Forest, California

***Lease rate for units highlighted in yellow are \$0.55 Gross**

CURRENT AVAILABILITY

Suite	Total Sq. Ft.	Office Sq. Ft.	Percent Office Space	Lease Rate	Comments
BLDG A. - 20371 Lake Forest Drive					
20371-A2	961 SF	356 SF	37%	\$1.10 Gross	Available in 30 days.
20371-A3	960 SF	356 SF	37%	\$1.10 Gross	Available July 1, 2011.
20371-A8	1,201 SF	360 SF	30%	\$1.10 Gross	Reception, private office, restroom and warehouse.
BLDG B. - 20381 Lake Forest Drive					
20381-B15	1,013 SF	1,013 SF	100%	\$1.10 Gross	One private office, reception, large bull pen area, restroom and coffee bar. Street frontage.
20381-B5	1,542 SF	540 SF	35%	\$1.10 Gross	One private office, reception, restroom, coffee bar and warehouse space. Street frontage.
20381-B18	1,680 SF	840 SF	50%	\$1.00 Gross	One private office, reception, open office/lab, restroom and warehouse space.
20381-B12	1,859 SF	1,153 SF	62%	\$0.55 Gross	Four private offices, reception, conference room, restroom and warehouse space.
20381-B17	1,561 SF	391 SF	25%	\$1.10 Gross	Available immediately.
BLDG. C - 20331 Lake Forest Drive					
20331-C12	1,995 SF	1,157 SF	58%	\$0.55 Gross	One private office, restroom, coffee bar, mezzanine office and warehouse space. Street frontage.
20331-C8	1,997 SF	1,158 SF	58%	\$0.55 Gross	One private office, restroom, coffee bar, mezzanine office and warehouse space. Street frontage.
20331-C9	1,997 SF	1,158 SF	58%	\$0.55 Gross	One private office, restroom, coffee bar, mezzanine office and warehouse space. Street frontage.
20331-C10	1,906 SF	1,105 SF	58%	\$0.55 Gross	One private office, restroom, coffee bar, mezzanine office and warehouse space. Street frontage.
20331-C11	1,906 SF	1,105 SF	58%	\$0.55 Gross	One private office, restroom, coffee bar, mezzanine office and warehouse space. Street frontage.
20331-C11/12	3,901 SF	2,262 SF	58%	\$0.55 Gross	Two private offices, two restrooms, reception, and large mezzanine office area. Street frontage.
20331-C9/10	3,903 SF	2,263 SF	58%	\$0.75 Gross	Two private offices, two restrooms, reception, and large mezzanine office area. Street frontage.
BLDG. D - 20321 Lake Forest Drive					
20321-D7	1,361 SF	1,225 SF	90%	\$1.00 Gross	One private office, restroom and warehouse space.

www.lee-irvine.com/foothillbusinesspark



ALLEN BASSO
Senior Vice President
License ID # 01298152
949.790.3130
abasso@lee-associates.com

RYAN HARMAN
Vice President
License ID # 01399616
949.790.3136
rharman@lee-associates.com

Lee & Associates - Irvine, Inc.
111 Pacifica, Suite 310
Irvine, California 92618
www.lee-associates.com



No warranty or representation is made to the accuracy of the foregoing information. Terms of sale or lease and availability are subject to change or withdrawal without notice.